

# Rotule SA BEM18-60-501-DURBAL - BEM18-60-501-DURBAL

<https://www.123roulement.ca/roulement-palier/rotule/sa/bem18-60-501-durbal>

## BEM18-60-501



male thread; maintenance free; adapter sizes according to DIN ISO 12240-4, series K

**DURBAL® heavy-duty rod ends with integral spherical plain bearing in stainless steel**

rod end housing: stainless steel 1.4301, rolled thread, surface with pickling treatment

joint ball: stainless steel, hardened and ground, surface superfinished

race: nylon / teflon / glass fibre compound

tolerances: see page 10

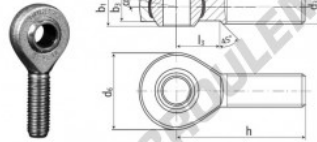

order number		measurements [mm]		weight		basic load rating dyn stat.		
type	right-hand thread	d <sub>1</sub>	d <sub>2</sub>	d <sub>3</sub>	h <sub>1</sub>	C	C <sub>0</sub>	
BEM 18 -60	-501	18	M 18 x 1,5	46	31,70	23	16160	46500

measurements [mm]		weight		basic load rating dyn stat.		
type	h	l <sub>1</sub>	l <sub>2</sub>	l <sub>3</sub>	α <sub>1</sub> <sup>1</sup> [°]	α <sub>2</sub> <sup>2</sup> [°]
BEM 18	72	44	25	15,0	9,5	0,250

## CARACTÉRISTIQUES PRODUIT

Marque	DURBAL
N° Ean13	3663952509822
Diam. intérieur	18 mm
Diam. extérieur	46 mm
Épaisseur	23 mm
Type	SA
Poids	250 g
Filetage	Filetage à droite
Lubrification	sans
Conditionnement	1

[contact@123roulement.ca](mailto:contact@123roulement.ca)

+33 359 360 490

CRT4 de Lesquin 60 Rue Du Haut De Sainghin 59273 Fretin FRANCE