

Rotule TAPR GIHR80-DO-DURBAL - GIHR80-DO-DURBAL

<https://www.123roulement.ca/roulement-palier/rotule/tapr/gihr80-do-durbal>

GIHR80-DO



Description: Hydraulic rod end. Made of spherical plain bearing DGE...ES pressed into rod end housing. Sliding combination steel / steel, with grease nipple.

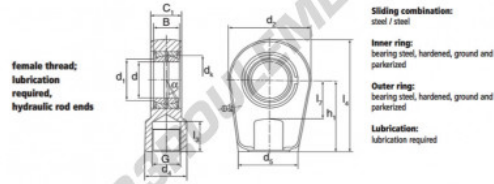

female thread:
lubrication
required,
hydraulic rod ends

Sliding combination:
steel / steel
Inner ring:
bearing steel, hardened, ground and
polished
Outer ring:
bearing steel, hardened, ground and
polished
Lubrication:
lubrication required

| order number | right hand thread | left hand thread | measurement [mm] | | | | | | |
|-------------------|-------------------|------------------|------------------|----------------|----------------|---------------------------------------|----------------|-----|--|
| GIHR 80 DO | 80 | 80,4 | M 80 x 2 | 105 | 160 | 55 | 60 | 176 | |
| type | measurement [mm] | | | d ₁ | d ₂ | load rating C ₀ [kN] | weight [kg] | | |
| GIHR / GIHL 80 DO | 81 | 80 | 170 | 265,0 | 92,0 | 6 | 12,00 | | |

CARACTÉRISTIQUES PRODUIT

| | |
|-----------------|-------------------|
| Marque | DURBAL |
| N° Ean13 | 3663952499819 |
| Diam. intérieur | 80 mm |
| Diam. extérieur | 176 mm |
| Épaisseur | 60 mm |
| Type | TAPR |
| Poids | 12000 g |
| Filetage | Filetage à droite |
| Lubrification | avec |
| Conditionnement | 1 |

contact@123roulement.ca

+33 359 360 490

CRT4 de Lesquin 60 Rue Du Haut De Sainghin 59273 Fretin FRANCE