

# Rotule TAPR GIHL30-DO-DURBAL - GIHL30-DO-DURBAL

<https://www.123roulement.ca/roulement-palier/rotule/tapr/gihl30-do-durbal>

## GIHL30-DO



**Description:** Hydraulic rod end. Made of spherical plain bearing DGE...ES pressed into rod end housing. Sliding combination steel / steel, with grease nipple.

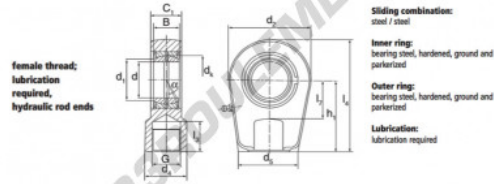

female thread:  
lubrication  
required,  
hydraulic rod ends

Sliding combination:  
steel / steel  
Inner ring:  
bearing steel, hardened, ground and  
polished  
Outer ring:  
bearing steel, hardened, ground and  
polished  
Lubrication:  
lubrication required

order number	d	d <sub>1</sub>	G	d <sub>2</sub>	B	C	d <sub>2</sub>
GIHL 30 DO	30	34,2	M 22 x 1,5	32	50	22	28 64

type	l <sub>1</sub> min	l <sub>2</sub> min	h <sub>1</sub>	l <sub>1</sub>	d <sub>1</sub>	α	load rating C <sub>0</sub> (N)	weight [kg]
GIHL / GIHL 30 DO	23	30	60	94,0	40,7	6	106	0,74

## CARACTÉRISTIQUES PRODUIT

Marque	DURBAL
N° Ean13	3663952499598
Diam. intérieur	30 mm
Diam. intérieur	1.181" inch
Diam. extérieur	64 mm
Diam. extérieur	2.52" inch
Epaisseur	28 mm
Epaisseur	1.102" inch
Type	TAPR
Poids	740 g
Filetage	Filetage à gauche
Lubrification	avec
Conditionnement	1

[contact@123roulement.ca](mailto:contact@123roulement.ca)

+33 359 360 490

CRT4 de Lesquin 60 Rue Du Haut De Sainghin 59273 Fretin FRANCE