

Rotule SA SAL30-ES-DURBAL - SAL30-ES-DURBAL

https://www.123roulement.ca/roulement-palier/rotule/sa/sal30-es-durbal

SAL30-ES



male thread:
lubrication
is necessary,
according to
DIN ISO 12240-4,
series E

Description: DIN ISO rod end E series. Made of spherical plain bearing DGE...E (ES) pressed into rod end body. Sliding combination steel / steel. Maintenance necessary. Bore diameter $d \geq 15$ with grease nipple in rod end body and lubrication groove and hole in inner and outer ring. Bore diameter $d \geq 15$ type DSA...ES-2RS with additional seals also available.

rod end body:
surface zinc plated

Sliding combination:
steel / steel

Inner ring:
bearing steel, hardened, ground and phosphated

Outer ring:
bearing steel, hardened, ground and phosphated

Lubrication:
lubrication is necessary

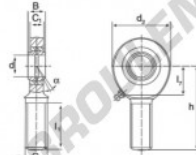

order number		measurement [mm]					
right hand thread	left hand thread	d	G	B	C ₁	d ₂	
	SAL 30 ES	30	M 30 x 2	22	19,0	73	
type	l ₁ min	l ₂	h	n [°]	load rating C ₀ [kN]	weight [kg]	
SA / SAL 30 ES	65	37	110	6	110,0	0,890	

CARACTÉRISTIQUES PRODUIT

Marque	DURBAL
N° Ean13	3663952498386
Diam. intérieur	30 mm
Diam. intérieur	1.181" inch
Diam. extérieur	73 mm
Diam. extérieur	2.874" inch
Epaisseur	22 mm
Epaisseur	0.866" inch
Type	SA
Poids	890 g
Filetage	Filetage à gauche
Lubrification	avec
Conditionnement	1

contact@123roulement.ca

+33 359 360 490

CRT4 de Lesquin 60 Rue Du Haut De Sainghin 59273 Fretin FRANCE