

# Rotule SI

## SI35-T-K-DURBAL - SI35-T-K-DURBAL

https://www.123roulement.ca/roulement-palier/rotule/si/si35-t-k-durbal

### SI35-T-K



female thread:  
maintenance free,  
according to  
DIN ISO 12240-4,  
series K



**Description:** DIN ISO rod end K series. Made of spherical plain bearing DG...PW pressed into rod end body. Sliding combination steel / bronze-PTFE composite.

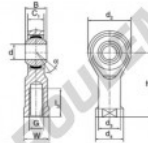

**Rod end body:**  
surface zinc plated

**Sliding combination:**  
steel / bronze-PTFE composite

**Inner ring:**  
bearing steel, hardened, ground and spherical surface chromium plated

**Outer ring:**  
brass body pressed around, outer race lined with bronze-PTFE composite

**Lubrication:**  
maintenance free

order number		measurement [mm]						
right hand thread	left hand thread	d	G	B	C <sub>1</sub>	d <sub>2</sub>	d <sub>3</sub>	d <sub>4</sub>
SI 35 TIK		35	M 36 x 2	43	28,00	81	46,0	58

type	measurement [mm]			h	d <sub>1</sub>	load rating C <sub>0</sub> [kN]	weight [kg]
	l <sub>1</sub> min	W					
SI / SIL 35 TIK	56	50	125	16			1,600

## CARACTÉRISTIQUES PRODUIT

Marque	DURBAL
N° Ean13	3663952489773
Diam. intérieur	35 mm
Diam. extérieur	81 mm
Epaisseur	43 mm
Type	SI
Poids	1600 g
Filetage	Filetage à droite
Lubrification	sans
Conditionnement	1
Norme	Sans norme

[contact@123roulement.ca](mailto:contact@123roulement.ca)

+33 359 360 490

CRT4 de Lesquin 60 Rue Du Haut De Sainghin 59273 Fretin FRANCE