

# Rotule SI

## SIL8-T-K-DURBAL - DSIL8-T-K-DURBAL

<https://www.123roulement.ca/roulement-palier/rotule/si/dsil8-t-k-durbal>

### SIL8-T-K



female thread:  
maintenance free,  
according to  
DIN ISO 12240-4,  
series K



**Description:** DIN ISO rod end K series. Made of spherical plain bearing DG...PW pressed into rod end body. Sliding combination steel / bronze-PTFE composite.

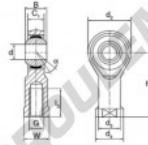

**Rod end body:**  
surface zinc plated

**Sliding combination:**  
steel / bronze-PTFE composite

**Inner ring:**  
bearing steel, hardened, ground and spherical surface chromium plated

**Outer ring:**  
brass body pressed around, outer race lined with bronze-PTFE composite

**Lubrication:**  
maintenance free

order number		measurement (mm)						
right hand thread	left hand thread	d	G	B	C <sub>1</sub>	d <sub>2</sub>	d <sub>3</sub>	d <sub>4</sub>
SIL 8 T/K		8	M 8	12	9,00	24	12,5	16

type	measurement (mm)			h	d <sub>1</sub> PT	load rating C <sub>10</sub> (N)	weight (kg)
	l <sub>1</sub> min	W					
SI / SIL 8 T/K	16	14	36	14	12,9	0,047	

## CARACTÉRISTIQUES PRODUIT

Marque	DURBAL
N° Ean13	3663952489155
Diam. intérieur	8 mm
Diam. extérieur	24 mm
Epaisseur	12 mm
Type	SI
Poids	47 g
Filetage	Filetage à gauche
Lubrification	sans
Conditionnement	1

[contact@123roulement.ca](mailto:contact@123roulement.ca)

+33 359 360 490

CRT4 de Lesquin 60 Rue Du Haut De Sainghin 59273 Fretin FRANCE